

KULLANIM KILAVUZU

OPERATING MANUAL

BEDIENUNGSANLEITUNG

GUIDE D'EMPLOI

MANUALE D'USO

GUÍA DEL USUARIO

РУКОВОДСТВО ПО
ЭКСПЛУАТАЦИИ

دليل كيفية الإستعمال

UĞUR TİCARİ TİP YATAY DERİN DONDURUCULAR

UĞUR COMMERCIAL TYPE CHEST FREEZERS

UĞUR HANDELS-TYP GEFRIERTRUHE

UĞUR CONGELATEUR HORIZONTAL DE TYPE COMMERCIAL

SURGELATOR HORIZONTAL DI TIPO COMMERCIALE UĞUR

CONGELADORES DE TIPO COMERCIAL HORIZONTALES UĞUR

ГОРИЗОНТАЛЬНЫЕ КОММЕРЧЕСКИЕ МОРОЗИЛЬНИКИ
«UĞUR»

مجمدات (ديب فريزر) أوغور الأفقية ذات النمط التجاري



UĞUR ŞİRKETLER GRUBU

UĞUR

"Tazeliğin Güvencesi"

EN

THIS MANUAL COVERS THE FOLLOWING MODELS

USD 1045 BK	UDD 260 BK
USD 2045 BK	UDD 360 BK
USD 3045 BK	UDD 460 BK
USD 4045 BK	UDD 660 BK
USD 2060 BK	UDD 300 BK
USD 3060 BK	UDD 500 BK
USD 4060 BK	UDD 600 BK

INFORMATION

Dear Customer,

In order to use more efficiently your deep freezer, which was manufactured and quality controlled in Uğur Soğutma A.Ş. plants with great care, we kindly request you to read this manual carefully and completely before starting using your product, to keep it for further reference and to use your product according to the terms stated herein.

If you fail to use your product according to the rules and instructions contained in this manual and/or in case of any usage error, our Company shall not be anyway responsible from the breaking down of your product.

You can find the updated version of the operating manual from our web site www.ugur.com.tr.

Bu ürün, çevreye saygılı modern tesislerde üretilmiştir. Çevre dostu teknolojiye sahiptir.

Dear Customer,

The product you bought was manufactured by using asbestos and CFC-free substances as well as compressor oil that does not contain PCB throughout the production process. The gases used in your Freezer are R404 or R600a. These gases conform to KYOTO Protocol.

Service life of your freezer is 10 years if the terms and instructions given in this manual are abided and ordinary conditions of use are provided.

Your product conforms to WEEE (Waster Electric and Electronic Equipment) Directive.



IMPORTANT

Dear Customer,

Always ensure that introduction and installation of your deep freezer, which was manufactured in Uğur Soğutma A.Ş. plants with great care, are always carried out by Authorized Uğur Service Team. Your product will not be under warranty in case of any failure if the introduction and installation of your deep freezer are carried out by a service other than Authorized Uğur Service.

Dear Customer,

Points to consider within this manual are indicated under the headings WARNING, CAUTION, NOTE and SUGGESTION

These headings are defined according to the degree of importance and we kindly request you to read each of them carefully.

The information stated under headings WARNING, CAUTION, NOTE and SUGGESTION in this operating manual applies for all stages during the period of use of your product, including transportation and installation.

WARNING!

Contains information for preventing serious damages, which may lead the product out of use, to injury, loss of life and property while the product is in use

CAUTION!

Contains information for preventing the errors, which may decrease the efficiency of your product or failures while the product is in use.

NOTE

Contains explanatory information while the product is in use.

SUGGESTION

Contains information that may be useful while the product is in use.

NOTE

Red temperature warning lamp will light until your deep freezer reaches to the coldness value set and will go out once the temperature reaches to the desired level. Red warning lamp continues to light if the internal temperature of your freezer fails to reach to the desired level. If the red warning lamp lights continuously for 24 hours, this may be an indication of a failure. Please contact to our Call Centre, nearest Authorized Uğur Service or Customer Care Centre for obtaining information. Our Customer Care Center hotline is available at last page of the operating manual.

It is at the discretion of the consumer to take action related to the food inside your freezer in case of any failure. Our company is not responsible from the deterioration of your foodstuff due to any failure or usage error.

Our products are manufactured for freezing foodstuff and beverages. Our company is not responsible for any damage that may occur in the products that are used for another purpose.

TABLE OF CONTENTS

A - Things that must be done before using your deep freezer and security warnings.

B - General appearance and of your deep freezer

C - Installation of your deep freezer.

D - Using your deep freezer

E - Cleaning, maintenance and transportation of your deep freezer

F - Things that must be done before calling Authorized Service

A- THINGS THAT MUST BE DONE BEFORE USING YOUR DEEP FREEZER

WARNING!

- Do not place your deep freezer to a place exposed to direct sunlight or influence area of the heat sources such as stove, radiator core, oven, cooker, radiant and infrared. Otherwise, this may cause performance decrease, damage of your freezer or make it become dysfunctional. (Picture 1)
- Your freezer is set for operating at mains power of 220-240 Volt 50 Hz. Using your freezer with a different voltage may cause it become dysfunctional and fire. (Picture 2)
- Electrical installation must conform to national regulations. (Picture 3)
- There must absolutely be a residual current relay and a fuse in your electrical installation for preventing the risks of electrical shock and fire. (Picture 4)
- Our company is not responsible for the failures and material damages that may occur in case of using without grounding. (Picture 5)
- Place the freezer in a damp-free place with unobstructed air circulation.
- You must clean inside your product before the first use. (see page 26)
- After placing your freezer to its place, wait for one (1) hour without moving it before starting using.
- If your freezer is installed under very cold weather conditions, then the waiting period must be at least two (2) hours before starting to operate it.
- Pack your foodstuff air-tight before placing them into the freezer for preventing them losing their tastes and not getting dry. (Picture 6)
- In case of prolonged blackouts, do not open the door of your products for preventing heat loss. If you do not use your freezer or leave it empty for a short time, do not unplug it for saving energy. Otherwise, more energy will be consumed for re-cooling your freezer.
- Locations of the lamps may change depending on your freezer's model. You can place your foodstuff into your freezer two (2) hours after the red temperature light goes out. For more cooling, your product is equipped with super cooling system. It is required to run super cooling function of your device during the first operation (for the models with super cooling option)
- Super cooling system will run for maximum 24 hours continuously. Otherwise service life of your freezer may decrease (For models with super cooling)



PICTURE 1

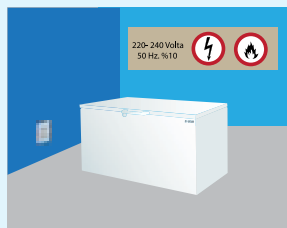

PICTURE 2

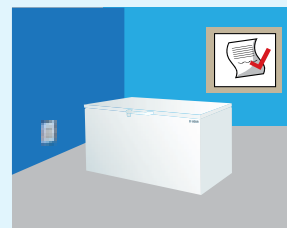

PICTURE 3



PICTURE 4

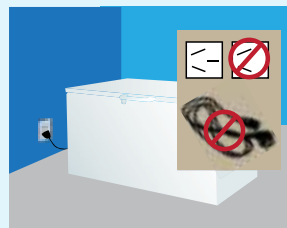

PICTURE 5

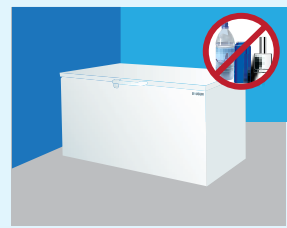

PICTURE 6

A- THINGS THAT MUST BE DONE BEFORE USING YOUR DEEP FREEZER

WARNING!

- In products, the doors of which are left opened or opened and closed continuously, frost deposit will increase and no cooling operation will be carried out. Thus open the doors only when needed. Make sure that the doors are closed if not required.
- Unplug your product in case of sudden blackouts. For starting again, plug in your product 20 minutes after the electricity is supplied. High voltage occurring at the moment of electricity supply may cause damage of your product and fire.
- Do not allow wild animals and pets to enter into your product or walk around it. It may damage your freezer or cause death and injury of the animals. Furthermore, wild animals and pets may cause fire by giving harm to the electrical installation.
- Your product does not have any sterilizing effect on the microorganisms. Therefore it is necessary that the foodstuff you place into your product must conform to the hygiene conditions. Otherwise, microorganisms reproducing in foodstuff may pose a threat for your health. (Picture 9)
- Making partial loading by loading the foodstuff to the loading basket first, then taking them to the lower part and adding new foodstuff as they are cooled down, rather than filling your product with full capacity once is a healthier freezing method. In full capacity loadings to be made at a time, cooling operation of your freezer may not be efficient as there will not be sufficient cold air flow.
- Do not contact new foodstuff to the frozen ones.
- When you place packages, which are not packed, properly packed and cause leakages, liquid leaks from the foodstuff may cause corrosion on the metal parts of your show case, gas leakage at the pipes, yellowing on the plastic parts, cracks and disappearance of the hygiene conditions, odour formation and reproduction of the microorganisms that may pose a threat for your health.
- Place the foodstuff to be placed into your freezer after checking their expiry dates.
- Do not use your products in the freezer until their expiry dates. Defrost and use foodstuff with close expiry dates. Otherwise they may cause poisoning.
- Never place hot foodstuff into your freezer for cooling or freezing purposes. Keep it under room temperature and cool in the refrigerator.
- Do not re-freeze foodstuff that were once frozen and defrosted. However you can freeze products again after re-processing (cooking, frying etc.) them. Otherwise, they may cause poisoning.
- Do not use any object other than the plastic ice shaver supplied with your product for shaving the ice. Otherwise, if you use sharp, pointed and metal objects, you may damage internal wall of your freezer. Furthermore, this may lead to gas leakage.
- Do not ever pour water or any other liquid for defrosting; never clean with steam cleaning devices. It may cause damage on your product or electric shock.
- Do not ever use a thermal source (electric heater, heater etc.) for accelerating defrosting. These heaters may damage plastic parts of your freezer.
- The freezer you've purchased is designed and manufactured for freezing foodstuff (for foodstuff that are capable of frozen storage and to be frozen for the first time) and storing frozen food only. Please do not use for other purposes. Our company shall not be responsible from the damage on the products that are used for purposes other than these.

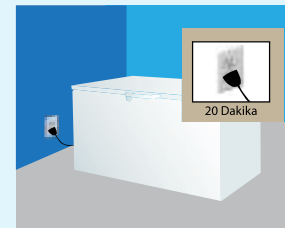

PICTURE 7



PICTURE 8



PICTURE 9

A- THINGS THAT MUST BE DONE BEFORE USING YOUR DEEP FREEZER

WARNING!

- Your freezer is designed for using at indoor places. Do not use your product at outdoor places.
- Do not place materials that must not be cooled down or frozen into your freezer. Do not use your product for defrosting frozen food.
- Freezer installation, placement, maintenance and cleaning must be done as stated in the manual. Do not apply anything contrary to the manual. In case of any damage that may happen in your freezer as the result of such use, warranty conditions will be invalid.
- Care must be taken for the products with glass doors as hitting them with a sharp, pointed object or contacting them with a very hot substance may cause them broken.
- Place your device onto a flat surface with no slope in order to prevent sliding or tilting of your device.
- Operate your device only in usage position.
- Do not expose your freezer to direct sunlight.
- Carry and store your freezer at normal using position only in order to protect it from damages. Actions in contrary may cause loss of the warranty rights.
- For preventing frost depositing in your product and high sweating on its glass, make sure that the discharge plug is closed.

NOTE

It is at the discretion of the consumer entirely to take action related to the food inside your product in case of any failure. Our company is not responsible from the deterioration of your foodstuff due to any failure or usage error.

The product you have purchased has been designed for freezing and storing packed food used for commercial purposes only. Our company shall not be held responsible for any damage that may occur on the products used for other purposes.

Check your product if there are any failures or not immediately after receiving the product you've purchased. If there is any damage, contact to your seller within 24 hours.

In order to use your product efficiently and safely, please read this manual entirely before starting using your product and keep it as a source of reference. You can find updated version of the operating manual on our web site www.ugur.com.tr or from our authorized services.

This product contains (WEEE) classification symbol, which indicates electric and electronic hardware. Accordingly, the user must conform to 2002/96/EC European Directive for recycling in order to minimize the environmental impact of the relevant product.

When you intend to throw your product to garbage or to allocate as scrap, please contact to Authorized Uğur Services for learning necessary information. Your device must be definitely delivered to local WEEE disposal institutions in such cases.

The pictures shown in this manual are representative only and may vary depending on the model. Since the specifications stated in this manual include all options, some of them may not be present at your product.

A- SECURITY WARNINGS

WARNING!

- The freezers mentioned in this manual are designed and manufactured under control according to national and international security norms. Following rules must be followed for a safe and secure use.
- Check that your outlet is suitable for the operation of your freezer. Always use your product with grounded socket. Make sure that electrical installation of your building is convenient. Do not use displaced and loose outlets.
- Do not ever use your freezer with extension cord or power strip.
- Always follow the instructions in this manual while replacing the bulb. The power of the bulb to be replaced is indicated on the device declaration name label, on the label just under the lamp and in this manual.
- If power cable is damaged, its replacement must only be made by Authorized Uğur Service. (Picture 10)
- Please call Authorized Uğur Service if you have any doubt about the electrical connection while the freezer is running.
- Always pull the plug of your freezer by holding it from the plug-head. Never pull the power cord.
- Do not remove any external protective cover that is not stated in this manual. You may access electrical parts posing threat to life if the external protective covers are removed.
- Never use pressurized water for cleaning. Pressurized water may cause damage in live parts.
- Do not handle the electrical issues by yourself. Do not forget that safety comes first.
- Never plug and operate a damaged (such as transportation damage) freezer. Certainly call an Authorized Uğur Service.
- Always consider maximum loading capacity while loading your product with frozen food. Do not exceed the loading line indicated in your product.
- Do not place defrosted products into your freezer again.
- If your product is damaged and not operated with properly, please unplug it. Transfer the load inside to a suitable place and immediately call service.
- Replacement for the live parts must only be made by Authorized Uğur Services.
- Always store packaging materials of your device out of reach of children. Packaging materials (nylon, styrofoam etc.) may pose danger for children.
- Asbestos and CFC-free substances as well as compressor oil that does not contain PCB are used in your product.
- The device you've purchased must not be used by physically (visual, audial) or mentally handicapped people, children and people with inadequate knowledge without surveillance of a person responsible for their safety. Children must be guarded while using the product and it must be ensured that they are not playing with the product. (Picture 11)
- Cleaning and maintenance of this device must not be performed by children.

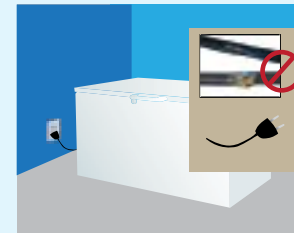

PICTURE 10



PICTURE 11

A- SECURITY WARNINGS

CAUTION!

- Do not use any material and metal that are not recommended by the manufacturer while defrosting. You may damage cooling parts.
- Do not damage cooling cycle components.
- Make sure that the intervention to be made to your freezer is certainly made by Authorized Uğur Service.
- Do not carry, move the freezer under any circumstance while it is plugged in.
- Never carry out servicing and repair operations on the freezer while it is plugged in.
- Products with explosive content, such as aerosol boxes containing flammable fuel must not be stored inside this device.
- Always abide positioning rules of your freezer. Not abiding freezer's shutter and grill layouts may cause fire danger.
- Please check the cooler gas written on the product label.

Following 5 clauses cover the products containing R600a and R290 Hydrocarbon gas only.

Installation of this device must be only made by Authorized Uğur Service for reducing flammability dangers.

Do not put obstacle on the ventilation holes on the device cover or body.

Mechanical tools and other apparatus, other than the ones recommended by the manufacturers, must not be used for accelerating defrosting.

Cooling circuit must not be damaged.

Electrical devices must not be used inside the food storage section of the device unless the models recommended by the manufacturer.

B- GENERAL APPEARANCE OF YOUR DEEP FREEZER

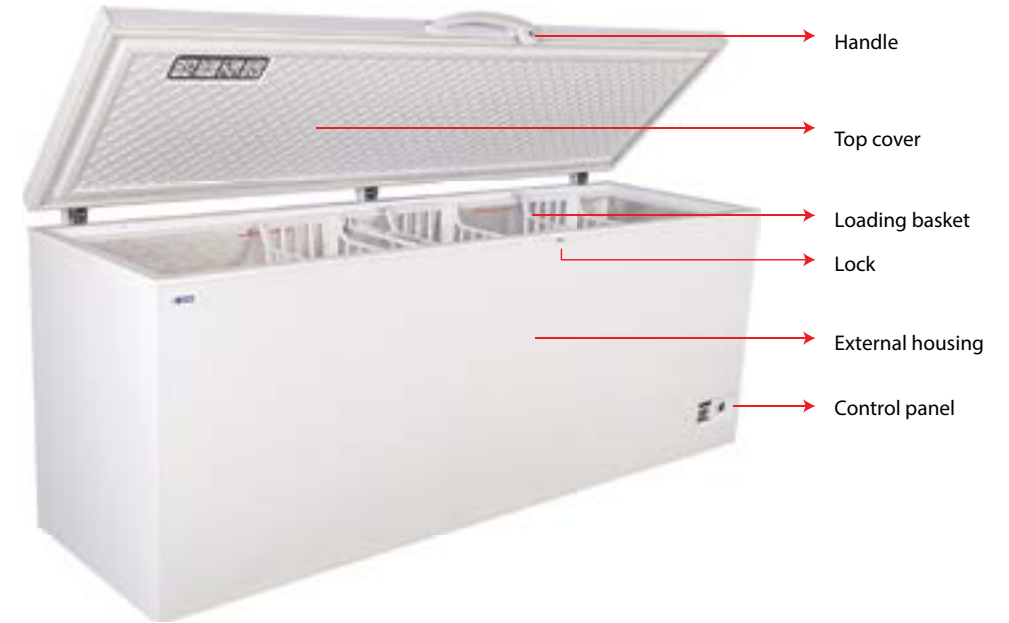

NOTE

Models indicated in this manual are commercial models. It is normal that they consume more energy and run noisier than domestic type products.

It is normal that external housing of your product is hot. It is not possible that such heat damages your freezer.

Energy consumption test standard in commercial type products is EN23953-2.

Technical Specifications of the Products are available on the labels.

Uğur Soğutma A.Ş. reserves the right to change technical specifications of the products written above without any notice.

C- INSTALLATION OF YOUR DEEP FREEZER

Selecting the place of installation

The operating environment of the product is very important for the smooth operation of your product. While selecting the operating environment,

Do not place your product exposed to outdoor environment (on the street, avenue, etc.).

Be careful for not obstructing lower shutter of the product with materials such as cardboard, box etc. for a proper cooling. (Picture 13)

Place the product at least one (1) meter away from heat resources (stove, radiator, electric heater etc.). (Picture 14-15)

Do not place it opposite to the air conditioner chutes, under fans and direct door and window openings. (Picture 16)

Do not expose to direct sunlight. Operation ratio will increase if sunlight comes to your cooler's glass. That means an increase in the energy consumption.

Air intake and outlet must absolutely be fluent and free for proper operation of the compressor section of your product.

While approaching your product to the wall, be careful that there is a gap of 150 mm (15 cm) between the wall and back of your cooler.

WARNING!

In very humid environments, ensure that floor and wall of the place where the freezer is located, is not affected by water; against discharge water overflow danger.

In installations performed by Authorized Uğur Service, Authorized Uğur Service shall inform the consumer on the suitable place for installation and make suggestion, but the consumer shall give the final decision on where the installation will be made. This above mentioned process shall also be stated on the relevant installation form by Authorized Uğur Service. In case of any loss arising from the place of installation of the product according to the final decision given by the consumer, all responsibility related to such loss shall belong to the consumer.

Your product gives the best cooling performance according to the climate condition under the conditions given below. Therefore, be careful that the temperature of the environment where your cooler will operate is at these levels.

In Commercial Products:

Climate Class	Acceptable Ambient Temperature
Class 3	Between +16°C and +25°C 60% Humidity
Class 4	Between +16°C and +30°C 55% Humidity
Class 5	Between +16°C and +40°C 40% Humidity

Climate Class of your product is indicated on the technical specification label on the product.



PICTURE 13

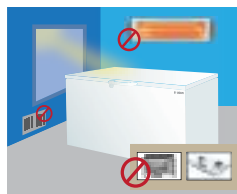

PICTURE 14



PICTURE 15



PICTURE 16

C- INSTALLATION OF YOUR DEEP FREEZER

Positioning

Possible placement positions:

1- In a way that the back side alone is opposite to the wall; be careful that there is a gap of 150 mm (15 cm) between the wall and your device. (Picture 17)

2- In a way that is place to a corner; when you place it to a corner, leave a gap of 150 mm (15 cm) behind. You can lean the side, corresponding to the corner, to the wall.

The most important point to be considered in all cases of product placement is not to obstruct ventilation of the compressor assembly.

Without exposing your product to any slope, place and operate it in a manner that it is on its feet or wheels.

The freer the compressor assembly ventilation is, the better the device will run.

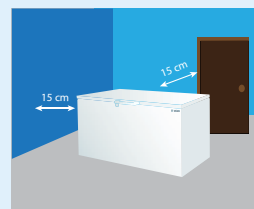

PICTURE 17

C- INSTALLATION OF YOUR DEEP FREEZER

Installation

Before positioning, remove and disassemble all packaging materials and bottom wooden pallet of the freezer. (It may be necessary to lift the cooler for removing the bottom pallet).

Insert the spare parts inside your product according to the installation instructions. Only use genuine Uğur spare parts.

Inauthentic spare parts may constitute danger for you and damage your product.

Place the product anywhere you desire. Consider the placement rules written in the manual while positioning the product.

Balance your product in width and in depth by means of a water gauge. Perform balancing operation by using adjustable feet at the bottom front of your cooler. (Picture 18)

In models with wheels (optional), wheel brake (optional) must be locked or if there is no wheel brake, it must be guaranteed that the device will not move after the positioning of the product.

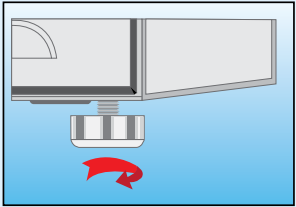

PICTURE 18

EN

C- INSTALLATION OF YOUR DEEP FREEZER

Electric Connection Rules

The product will start when you insert the plug into the outlet as shown in picture 19.

WARNING!

It is forbidden to insert the plug into multiple socket and to use extension cord. (Picture 20)

There is no separate on-off switch on your product.

Do not contact the cables of your product, which are connected to the mains, to hot surfaces.

The outlet you will use must be grounded. Furthermore, the outlet to be used must have the resistance of at least 10-16 A and be protected with a suitable fuse. Definitely take assistance from our technical service or a competent electrician with regards to the fuse that should be present on the mains where the outlet is connected.

Mains voltage and frequency must be same with the value written on the label inside your product. If your mains voltage is extremely below or above the value indicated, definitely supply demanded voltage by using a voltage regulator. You can get assistance from an expert electrician with this regard.

Do not place your product's cord onto passageways. This may cause you to get injured and damage your cooler. (Picture 21)



PICTURE 19

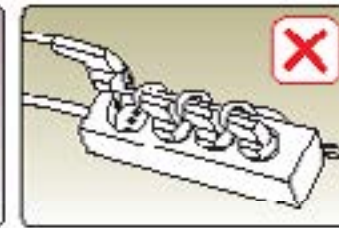

PICTURE 20



PICTURE 21

EN

D- USING YOUR DEEP FREEZER

Start-up

WARNING!

- Bu This operating manual applies for various device models. Hardware scopes of the models may vary. There may be differences in the pictures.
- Clean inside and all accessories of your product before the first start up. (see page 21).
- If your product has been shaken so much during the transportation and positioning, wait for one (1) hour without running your freezer. Thus, the compressor oil, which may enter into the system, will return back. You may damage the compressor if you run it without considering this.
- Insert your product's plug into an outlet with alternative current of 220-240V/50 Hz only, which has been installed according to the regulations. (Picture 22)



PICTURE 22

You will hear a slight sound from the compressor when your product is running.

Green and red check lamps will light upon turning on your product.

Upon first operation of your product, press fast (super) freezing button in yellow colour. Thus your freezer will make deeper freezing.

Control Panel (Optional)

Indicators and controls on the control panel of your products are shown in Picture 23 below.

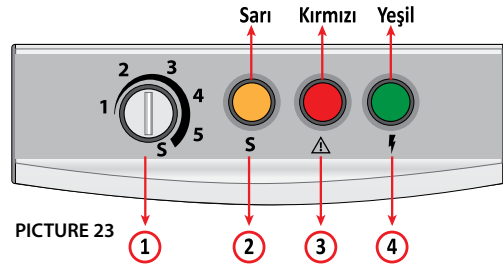

PICTURE 23

Alternative control panels

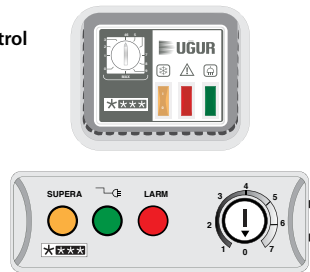

Alternative control panels

- 1) Thermostat setting button for setting the internal temperature of your product: When you put the thermostat setting to "S" position or press the super button for the first time, you will run fast (super) freezing function that you can use during the initial operation or when you want a faster freezing.
- 2) Fast (super) freezing lamp (yellow light) that you can use during the initial operation or when you want a faster freezing.
- 3) Alarm indicator that warns you with red light when internal temperature of your product reaches to critical levels.
- 4) Energy lamp showing your product is powered (Green light).

D- USING YOUR DEEP FREEZER

Control Panel

Green warning light will be on as long as your product runs.

Yellow light will be on when you press fast freezing button.

Red warning light will be on when the door of the freezer remains open for a long time or when you load fresh food. The light will go off after closing the door or food starts freezing.

NOTE

Control panel on your product is not available for every model and it may vary in some models.

Place of the indicator lights and buttons on your product may be different than the ones shown herein. Thus be careful to the colours stated in the control panel section.

Setting the Internal Temperature of your Product

Internal temperature of your device has been factory set in a manner that it will protect your food without causing them spoiled.

In some models, the thermostat of your product is at compressor section. The temperature you desire can be set by Authorized Uğur Service if requested.

When you run your product at factory set value, you get the best result in terms of both the performance and energy consumption.

Run your device empty for at least three (3) hours. Therefore inside of your product will be cooled down in the best way.

You can set internal temperature of your product through the thermostat on the control panel:

You can set the thermostat by using a coin etc. that can enter the opening on the button. (Picture 24)

There are min-max and numbers between them on the thermostat button.

Operating ratio of your product will increase as you shift the button toward the position "MAX" and thus you will gain more cooling.

Operating ratio of your product will decrease as you shift the button toward the position "MIN" and thus you will gain less cooling.

Factory set thermostat value of your product is position (four) 4. This position is the most efficient position of the freezer in terms of cooling and energy consumption.

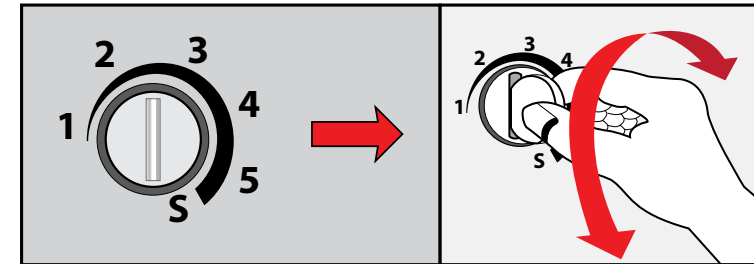

PICTURE 24

The temperature can be set between -40°C and -45°C for UCF- SLF series freezers

The temperature can be set between -60°C and -65°C for UCF-LF series freezers

Internal temperature of your product can be set between -18°C and -25°C for freezers of other type.





D- USING YOUR DEEP FREEZER

Using digital thermostat

If the product you've purchased is equipped with a digital thermostat, please pay attention to the following matters. Digital thermostats are factory set and do NOT require any setting. You can change the thermostat setting as shown below.

Digital thermostats contain many programs (such as eco mode, night mode). If you believe that there is a problem in your product related to the operation or cooling, please consult to authorized service.

Error codes given by the digital thermostats are under the troubleshooting title. When you encounter these error codes, stop thermostat alarm and call Authorized Uğur Service.

 Turns on/off your cooler.	 Manuel defrost.
 Mutes alarm.	ECO   Shifts to economic mode and night mode.

For Carel Thermostat;



Temperature is increased by pressing this button after setting the device temperature. It is activated when set button is pressed for 2-3 seconds.

Temperature is decreased by pressing this button after setting the device temperature. It is activated when set button is pressed for 2-3 seconds.

Temperature is decreased by pressing this button after setting the device temperature. It is activated when set button is pressed for 2-3 seconds.



Resetting key. Only used by service personnel.

Power on/off function. Temperature is increased by pressing this button after pressing set button simultaneously.

Manual defrost of the product. Temperature is increased by pressing this button after pressing set button simultaneously.

Temperature is decreased by pressing this button after pressing set button for 2-3 seconds.

D- USING YOUR DEEP FREEZER

Using digital thermostat

For Dixell Thermostat;



Ensures manual defrost of the product.

Temperature is increased by pressing this button after pressing set button.

Temperature is decreased by pressing this button after pressing set button.

Allows setting the cooler temperature. It is activated when set button is pressed for 2-3 seconds.



Allows setting the cooler temperature. It is activated when set button is pressed for 2-3 seconds.

Temperature is increased by pressing this button after pressing set button.

Ensures manual defrost of the product.

Temperature is decreased by pressing this button after pressing set button.

D- USING YOUR DEEP FREEZER

Loading foodstuff to your product

You can load your foodstuff as permitted in this manual after your product reaches to desired temperature at empty state. (If your product is a thermometer installed model, you can control internal temperature of your product from here.)

CAUTION!

Before loading your freezer with foodstuff, run your cooler empty for three (3) hours.
Do not load your product with food over the loading line.

Defrosting

Your product has manual defrost.

If there is excessive frost deposit on the walls of your device, this will lead decrease in the cooling capacity and increase in energy consumption.

Clean the walls with frost deposit by means of a frost shaver supplied with the device without damaging the walls.

If the frost deposit and the its thickness is high, place the products inside of your device to another suitable environment that prevents them to get spoiled.

Unplug your product. Frost deposit generally melts in two (2) hours.

Place a container at water discharge for preventing the melted ice waters to damage the floor.

After defrosting operation, wipe internal walls with a dry cloth to make sure that they are not wet.

Run your device empty again for three (3) hours and wait for it to cool down. Then you can place your foodstuff in it.

D- USING YOUR DEEP FREEZER

Shutting down your product

Transfer the foodstuff inside your product to a convenient place.

Unplug your product. (Picture 29)

If your product will not be used for a long time, apply following considerations;

Clean your product. Otherwise the humidity on the wall may cause darkening of the internal surface.

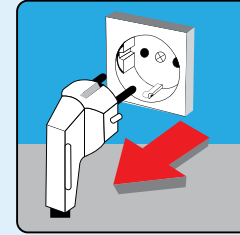

PICTURE 29

CAUTION!

If your product will be stored at an indoor place after shutdown;

Do not cover it with plastic sheets. Plastic will cause smell and sweating of your product as it does not breathe. Corrosion may be seen as the result of sweating.

Smell formation may occur in cases where you fail to store your product with the door open.

E- CLEANING, MAINTENANCE AND TRANSPORTATION OF YOUR DEEP FREEZER

CLEANING

Cleaning of your device is composed of two stages, which are the internal cleaning and external cleaning. Following warnings must certainly be abided before start cleaning.

CAUTION!

Unplug your deep freezer before every cleaning.

Always wear protective gloves during cleaning and maintenance. This will protect you from injuries.

Never use abrasive and scratching substances (flammable and sparking, solvent like gasoline, thinner, acid) as cleaning agents. Never use flowing and pressurized water for cleaning. (Picture 30-31)

Do not wash inside and outside of your product. It may damage your product and cause electrical shock. (Picture 32)

If the place where your product is installed is a wet and humid place, external dye of your product may be damaged. It must be moved another place free of damp and humidity

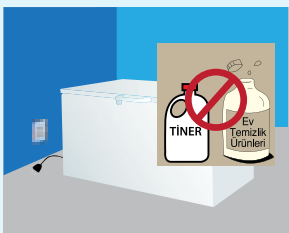

PICTURE 30



PICTURE 31



PICTURE 32

Internal cleaning

Transfer the foodstuff inside your product to a convenient place.

Before the internal cleaning, wait until the temperature of the internal parts of your product reaches to the ambient temperature.

Always wear protective gloves during cleaning and maintenance. This will protect you from injuries.

Remove the accessories from inside.

Perform cleaning with a soft cotton cloth and warm soapy water or by using the cleaning agents recommended by Uğur Soğutma A.Ş.

Dry with a dry cotton cloth. Products, which are not dried, may darken in time.

Make sure that no wet or humid area is left in the internal section after cleaning.

You can reload your product three (3) hours after running your product as stated in this manual.

External cleaning

Clean with a cotton cloth and warm soapy water.

Prevent penetration of cleaning water into the front control panel and lighting section while cleaning. (Picture 33)

Clean the door gasket by using clean soapy water only.

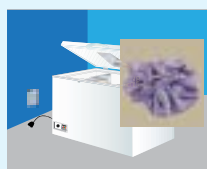

PICTURE 33

Maintenance

This product does not require periodical maintenance.

SUGGESTION

You can use Uğur branded cleaning agents, which you can get from Authorized Uğur Services for internal and external cleaning of your device.

E- CLEANING, MAINTENANCE AND TRANSPORTATION OF YOUR DEEP FREEZER

Transportation of your product

Unplug your product from the grounded outlet.

Carry out defrost operation.

Carry your product at normal using position. Do not carry horizontally, vertically, tilted or with the door open.

Protect your product from the impacts while carrying. Do not carry your product when it is plugged in or full.

In order not to cause any accident or for preventing the product to get damaged by falling or sliding, secure your product to the vehicle during the transportation.

NOTE

Pay attention to the following considerations if you do not use your product for reasons such as vacation, trip etc.

If you do not use it for a short time:

Leave your product in operating state.

If you do not use it for long time and want to shut it down:

Consume the foodstuff inside your product and empty it.

Unplug the power cord from the outlet. (Picture 34)

Apply defrost and internal cleaning steps in this manual.

Dry inside of the product thoroughly. Darkening may occur in the product which is not dried. (Picture 35)

Leave the product door open. (Picture 36)

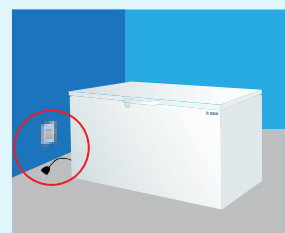

PICTURE 34



PICTURE 35

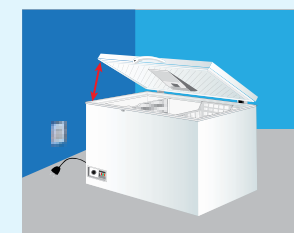

PICTURE 36

Troubleshooting

The failures and solutions stated in this section can be performed easily by yourselves and always consult to an Authorized Uğur Service if these suggestions do NOT solve your problem.

CAUTION!

- Intervention to any failure that may occur in your product must be carried out by Authorized Uğur Service.
- Any intervention that may be done by you may harm you, your employee or customer, invalidate the product guarantee and cause material damage (fire etc.).
- In case of any failure, consult to Uğur Customer Care or Authorized Uğur Service. (see Page 20)

Troubleshooting	Possible Solution	Result.
Cooler is NOTE working. (No sound or only fan sound comes from the product.)	It may be due to the thermostat NOTE plugged in. The fuse may be blown or broken down. Condenser lamella may be obstructed or get dirty.	It will run again when reached to the suitable temperature. Insert the plug properly. Consult to an Authorized Uğur Service or a competent electrician. Clean the condenser lamellas.
Device internal temperature is high.	External ambient temperature is very high or wrong thermostat setting. Very close to the back wall, ventilation shutters are obstructed or it's front is prevented. It may have been expose to excessive external wind. Condenser lamellas are very dirty.	Move the cooler to a place where the external temperature is lower. Adjust to the stated gap. Clean in front of the ventilation shutters. Prevent the wind. Clean the condenser lamellas.
Device internal temperature is very low.	Wrong internal thermostat setting.	Re-set the thermostat.
High degree of sweating on the glass and inside the device.	Water discharge hole may be obstructed when sweating is seen inside the cabin. In glass sweating on the other hand, current external ambient humidity is over 65%.	Clean water discharge hole. With regards to the high humidity, you can move your cooler to an environment with less humidity.
Bad smell coming from the bottom part of the cooler.	Lower water discharge tray is dirty.	Su tahliye tavasını temizleyiniz.

Ürünlerinizde kullanılan lamba veya ledlerin güç değerleri lambaların takılı olduğu bölümde olup üründen ürüne değişiklik göstermektedir. Ürünlerinizde kullanılan lamba veya ledlere sadece Uğur Yetkili Servisleri müdahale edebilir.

Digital thermostat failures

Alarm signals for Dixel thermostat;

MESSAGE	REASON	PROCEEDINGS TO BE FOLLOWED
P1	Room sensor failure	Check the sensor connection
P2 sen	Evaporator sensor failure	Check the sensor connection before replacing the sensor.
HA pa-	Maximum temperature alarm	Check compressor operation and relevant parameter values.
LA pa-	Maximum temperature alarm	Check compressor operation and relevant parameter values.
EA	External alarm	Alarm stops automatically when digital entry is deactivated.

Alarm signals for Carel thermostat;

MESSAGE	REASON	PROCEEDINGS TO BE FOLLOWED
EO	Control sensor 1 failure (Control)	Check the sensor
E1	Control sensor 2 failure (Defrost)	Check the sensor and d0=0/1/4,F0=1
E2	Control sensor 3 failure (Condenser)	Check the sensor and whether it is (A4=10)
IA	External alarm	Check external alarm outlets or A4 and A7 parameters.
dOr	Open door alarm	Check that the door is closed or A4 and A7 parameters.
LO	Low temperature alarm	Alarm will be turned-off automatically when the temperature returns to the set value range. Also check the set value.
HI	High temperature alarm	Alarm will be turned-off automatically when the temperature returns to the set value range. Also check the set value. Check whether the cooling system runs properly.
EE/Eer	Unit parameter failure	Check the parameters.
EF	Operating parameter failure	Check dT,dP and d4 parameters; defrost effect. Alarm will be closed automatically when defrost operation finishes.
ED	Defrost completed out of its time	dT, dP ve d4 parametrelerini; defrost etkisini kontrol et. Defrost işlemi normal olarak bittiğinde alarm kapanacaktır.

Setting the digital thermostat values other than the factory settings are completely under the user's responsibility. Our company shall NOT be held responsible for the material and moral losses that may arise in connection thereto.

F- THINGS THAT MUST BE DONE BEFORE CALLING AUTHORIZED SERVICE

Alarm signals for Elstat thermostat;

Alarm signals for Elstat thermostat;

MESSAGE	REASON	PROCEEDINGS TO BE FOLLOWED
=	Door is open	Check the product's door.
rSF	Cooling system failure	Check compressor operation and relevant parameter values.
PF1 PF2	Sensor failure Cabinet and condenser sensor	Check the sensor Check parameter values.

Setting the digital thermostat values other than the factory settings are completely under the user's responsibility. Our company shall NOTE be held responsible for the material and moral losses that may arise in connection thereto.



Fabrika : Yeni Sanayi Mahallesi Devlet Karayolu
Caddesi No: 127/C Nazilli - AYDIN
Tel: 0.256 316 10 00 (pbx) Faks : 0.256 316 10 31

Bölge Müdürlüğü: Mahmutbey Mahallesi Peyami
Safa Caddesi Doğukan Sokak. Uğur Plaza No: 9
Bağcılar - İSTANBUL
Tel: 0.212 624 32 28 (5 Hat) Faks: 0.212 598 94 26

ugur@ugur.com.tr - www.ugur.com.tr